

卡丽 KARAT®

安装说明书 INSTALLATION INSTRUCTIONS

KARAT SAFTY BAR - L SHAPE (WHITE)
卡丽L型安全扶手 (白色)
77657T-WK

BEFORE YOU BEGIN

- please carefully read this installation instruction in order to ensure proper care and assembly of this accessory.
- Please keep this installation instruction for future reference.



Prior to drilling into walls, check there are no hidden electrical wires, cables or water supply pipes with the aid of ar, electronic detector. If you use power tools do not forget:

1. Wear eye protection.
2. Unplug equipment after use.

安装之前

- 在您安装之前请详细阅读此说明书。
- 请保留此说明书以备参考。



警示：在钻孔之前，请借助电子探测仪确认墙内是否有电源线，通讯光缆或者水管之类的东西。如果使用电钻的话请勿忘记以下两点：

1. 请戴上防护镜。
2. 用完设备后关掉电源。

TOOLS AND ACCESSORIES

工具及配件



Drill
电钻

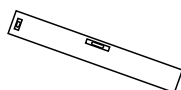

Leveling Instrument
水平尺

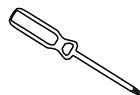

Screw Driver
螺丝刀



cover decoration hats
面盖装饰帽



Allen wrench
内六角扳手

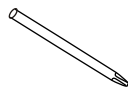

pencil
铅笔



Tape
卷尺

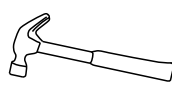

Hammer
锤子

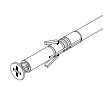

Screw and expansive colloidal particles
螺钉，膨胀胶粒

ROUGHING-IN

尺寸图

Reference Value
参考值

Unit: mm
单位: 毫米

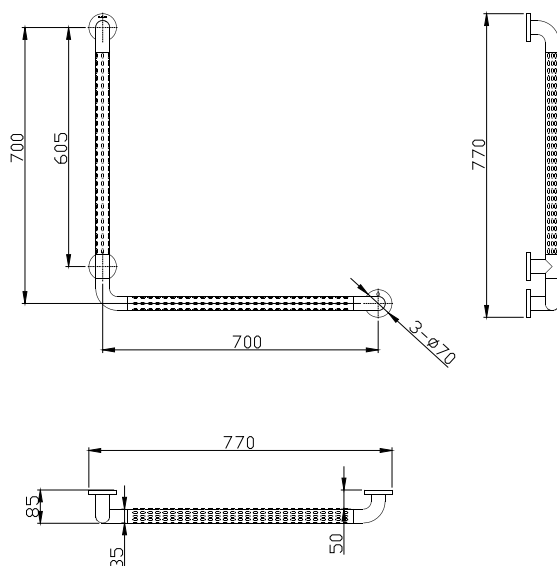

公司保留随时变更图中标示尺寸的权利，无需另行通知。
Our company reserves the right to change marked dimensions without prior notice.

INSTALLATION

1, 部件A和B中间加垫圈组装, 拧紧。

1, Add the gasket in the middle of A and B, Assemble and tighten.

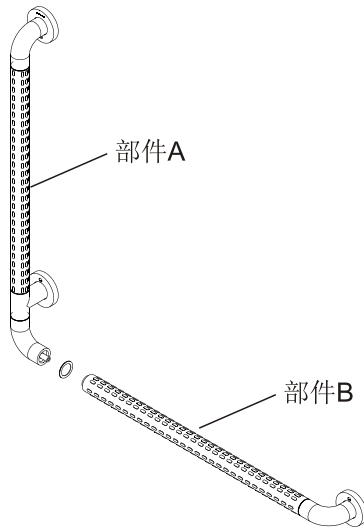

安装

2, 产品放在要安装的墙面, 用铅笔标识螺丝孔位置。

2, Put the product on the wall to install, with a pencil identifies the location of the screw holes.

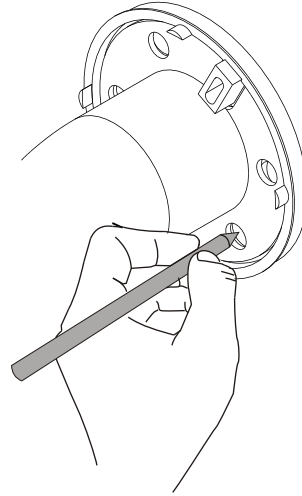

3, 在标示处钻孔, 用8mm钻头打孔, 深度约70 mm。

3, Drilling hole, with 8mm drill holes and the depth of about 70 mm.

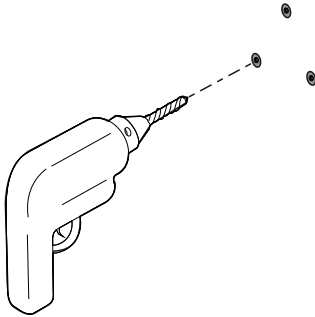

4, 将膨胀胶粒放入孔中, 扶手底座螺丝孔对准孔位, 旋紧固定螺丝即可。

4, Put swell colloidal particles into the hole, the armrest base screw holes aimed at the hole location. Just tighten the screws.

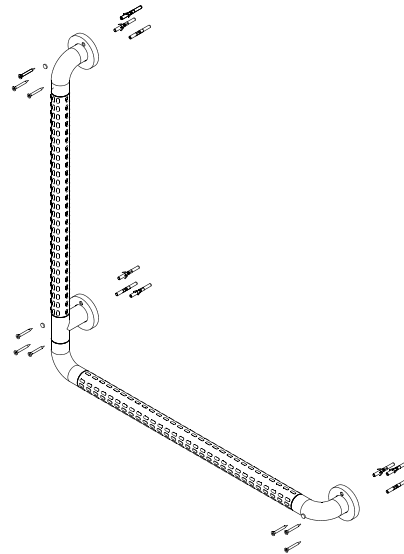

CARING FOR YOUR PRODUCTS

1. Clean the product daily with cotton cloth.

Do not use abrasive materials.

2. Do not use strong chemical detergents such as strong acid, strong alkali or phosphoric acid.

3. Avoid scratching product surface with sharp objects.

保养须知

1. 要经常除尘, 因为灰尘每天都会粘在产品的表面。最好使用干净的纯棉针织品作为抹布。

切记: 请避免使用粗, 磨料和钢丝球擦拭。

2. 请勿使用强力化学剂清洁 (强酸, 强碱或磷酸消毒剂)。

3. 产品表面经过 打磨和抛光处理, 避免有尖锐的硬物刮碰表面。

ONE -YEARS WARRANTY

一年有限担保

Our company provides one years warranty for its drain. Our company will at its election, repair, replace or make appropriate adjustment where our company inspection discloses any such defects occurring in normal usage within warranty.

The warranty, including products, is limited clearly. Our company is not responsible for other damages appeared after the warranty. Also, the warranty dose not cover problems arising from labor charges, incorrect use and installation.

本产品自购买之日起，在正常使用情况下我司将提供一年的质量担保，经核查后，我司有权决定是修理，更改，还是做适当的调整。

这里的担保，包括产品都已明确地限制在该担保期内。本公司对以后出现的损坏不负有任何责任。担保也不包括外观损伤，使用不当及未按说明书安装的损失。

Shanghai Kohler International Trade Co., Ltd.
Address: Room 1348, Floor 13, No.55, Xi Li Road,
China (Shanghai) Pilot Free Trade Zone
Tel: 400-920-8262
Postcode: 201206

上海科勒国际贸易有限公司
地址：中国（上海）自由贸易试验区西里路55号13层
1348部位
电话：400-920-8262
邮编：201206

卡丽 K A R A T®

维修零件图 SERVICEPARTSPAGE

KARAT SAFTY BAR - L SHAPE (WHITE)

卡丽L型安全扶手 (白色)

77657T-WK

