

### BEFORE YOU BEGIN 安装之前

Please read these instructions carefully to familiarize yourself with the required tools, materials, and installation sequences. Follow the sections that pertain to your particular installation. This will help you avoid costly mistakes. In addition to proper installation, read all operation and safety instructions.

All information in these instructions is based upon the latest product information available at the time of publication.

请仔细阅读说明书，熟悉所需工具、材料和安装顺序。参照相关章节完成您所需的安装，以避免昂贵的损失。除了正确的安装外，请详阅所有的操作和安全说明。

本说明书所含的一切资料均以印刷时所有的最新产品为准。

### INSTALLATION CONDITIONS

\* Make sure that the Inlet pipe is available, and flushed by water before installation, so that the pipe is free from jam.

\* The inner diameter of the water-inlet pipe is fitted to the product.

### 安装环境

\* 安装前应确认进水管路是否已正确安装完毕，并已用水进行过冲洗，确保进水管路内无杂质。

\* 进水管通径应与本产品一致。

### FEATURES AND FUNCTIONS

\* Time-lapse flushing and auto shut-down.

\* Cupule-like gasket proof, which is suitable for both super high and low hydraulic pressure.

\* Simple and elegant design; easy installation and operation.

### 产品性能特点

\* 具有延时冲洗、自动关闭功能。

\* 吸盘式橡胶圈关水，能适应特高水压和低水压密封。

\* 外形简洁美观，安装维修方便，操作简便。

### FUNCTION PARAMETERS

Normal Diameter DN	Φ15	Applicable Medium	Water
Inlet Pipe Thread	G1/2	Medium Temperature	1°C~50°C
Pressure Operating Range	0.10~0.90MPa	Average Water Consumption	≤2.5L
Recommended Pressure	0.17~0.55MPa	Water Regulation Range	1.0~2.5L

### 产品性能参数

公称通径DN	Φ15	适用介质	Water
进水接管螺纹	G1/2	介质温度	1°C~50°C
压力工作范围	0.10~0.90MPa	平均用水量	≤2.5L
推荐供水压力	0.17~0.55MPa	水量调节范围	1.0~2.5L

## ROUGHING-IN

### 尺寸图

UNIT: mm  
单位: 毫米

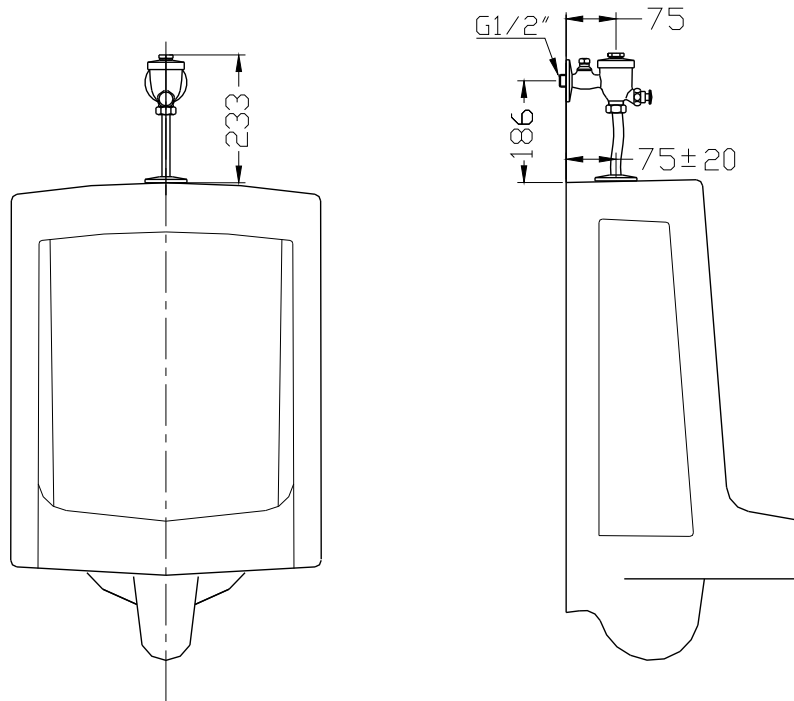

## INSTALLATION

According to the schematic, screw the valve to the embedded G1/2 screw thread (Seal the connecting part by twining some rubber tape to the connecting part).

Based to applicable installation offset range and length of the outlet pipe, position the urinal and then fix it to the wall.

Fit the gasket and the flange to the urinal, insert the outlet pipe, and then screw the nut.

### 安装说明

按图示顺序将主体安装在已经预埋好的G1/2管道螺纹上，（螺纹连接部位缠上适量生料带，增强密封效果。）。

根据“小便管”的可安装偏心范围及长度，确定好“小便器”所需的固定位置。将“小便器”固定在墙面上。

在小便器上依次装入“上进水接头组件”及“装饰盘”，然后插入“小便管”旋紧螺母即可。

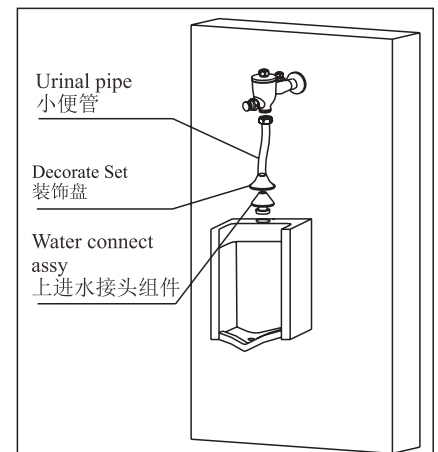
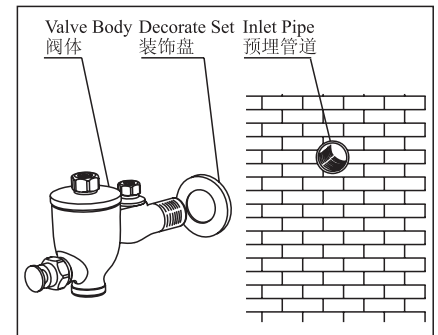

## INSTALLATION-COMPLETE SCHEMATIC

### 安装效果图

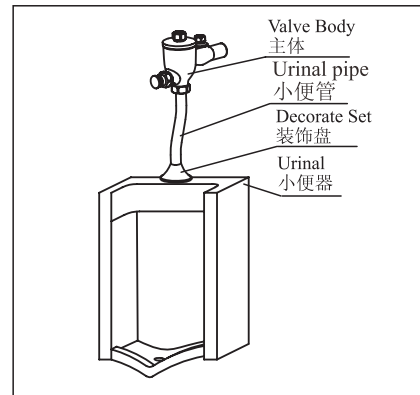
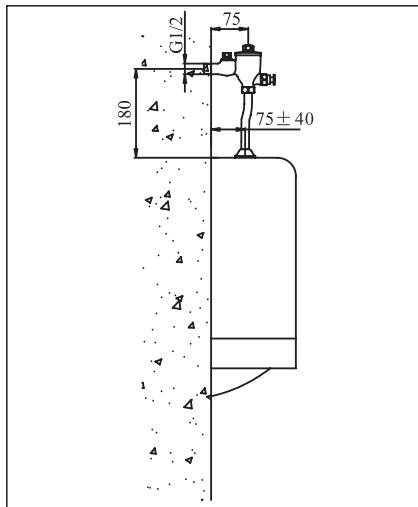

## ADJUSTMENT

Adjust the urinal flushing time: turn the screw 1. Turning clockwise is for shortening the time, so as to save water.

Shut down the inlet water flow: Turn the screw 2 clockwise to shut down the inlet water flow.

### 调节

小便阀冲洗时间的调节：可调节图示螺钉1，顺时针调节螺钉为冲洗时间减短，从而达到节水的效果。

阀体进水源的关闭：如需要关闭阀体前端的进水，可将螺钉2顺时针旋紧，关闭阀体进水。

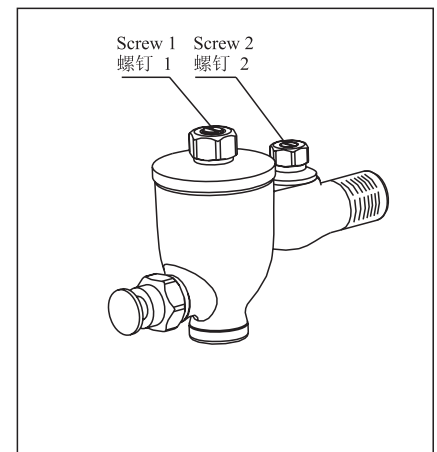

## TWO-YEARS WARRANTY

This product is 2 years warranted from date of purchase. We will be responsible for any problems caused by manufacturing defects provided with the invoice. We will, at its election, repair, replace or make appropriate adjustment where. We inspection discloses any such defects occurring in normal usage within one year after purchase.

Damages to the product caused by misuse, abuse and installation that is not in accordance with the owner s manual are not covered by this warranty. This is our exclusive written warranty.

### 二年有限担保

本产品自购买之日起即获得本公司2年的质量保证。凭购货发票，本公司将免费承担由制造质量引起的任何问题。经核查后，本公司有权决定是修理、更换还是作适当的调整。

担保也不包括外观损伤、使用不当以及未按说明书安装的损失。这是我们全部的书面担保。

Shanghai Kohler International Trade Co., Ltd.  
Address: Room 1348, Floor 13, No.55, Xi Li Road,  
China(Shanghai) Pilot Free Trade Zone  
Tel: 400-920-8262  
Postcode: 201206

上海科勒国际贸易有限公司  
地址：中国(上海)自由贸易试验区西里路55号13层1348部位  
电话：400-920-8262  
邮编：201206

