

卡丽 K A R A T®

安装说明书 INSTALLATION INSTRUCTIONS

KARAT POP-UP LAVATORY WASTE

卡丽玄采弹跳式下水

26891T-CC1

BEFORE YOU BEGIN

Please read these instruction carefully familiarize yourself with the required tools, materials, and installation sequences. Follow the sections that pertain to your paticular installation. This will help you avoid costly mistakes. In addition to proper installation, read all operating and safety instructions. All infrmation in these instructions is based upon the latest product infromation available at the time of publication. Karat reserves the right to make changes in product characteristics, packageing, ro availability at any time without notice. These instructions contain important care, cleaning, and warranty information, **please leave instructions for the consumer**

安装之前

请仔细阅读说明书，熟悉所需工具、材料和安装顺序，参照相关章节完成您所需的安装，以避免昂贵的损失，除了正确的安装外，请详阅所有的操作和安全说明。

本说明书所含的一切资料均以印刷时所有的最新产品为准，卡丽公司保留权利随时更改产品特性、包装或供应情况，恕不另行通知。

本说明书也包含了有关保养、清洁及产品担保等重要信息请交予用户保存。

ROUGHING-IN

尺寸图

Reference Value
参考值

Unit: mm
单位: 毫米

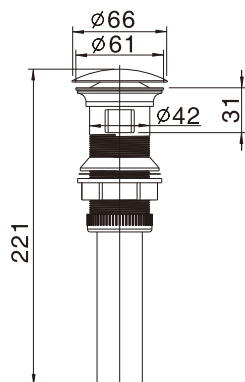

INSTALLATION

安装

HOW TO INSTALLAATION THE WASTE

Screw off the fixing nut and gasket and washer from the body as is shown in the picture.

安装去水
如图所示，从落水本体上取下固定螺母及止水密封圈、垫圈。

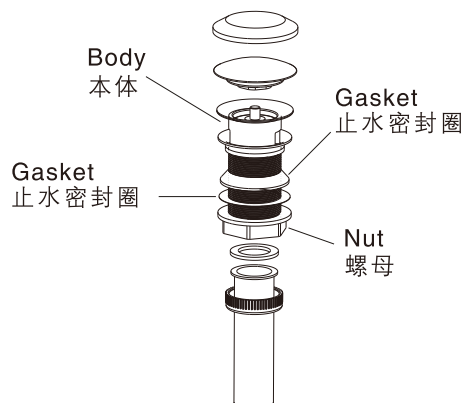

Insert the body of the rainspout from the water outlet of the basin, apply some sealant to the top of the drain of the basin and install the rainspout with water-tight washer and fixing nut from the bottom of the basin. (Note: Don't do that with great impetus, to prevent breaking the basin.)

将落水本体及止水密封圈从脸盆的落水孔穿过，抹少许密封剂在脸盆的下水口顶部，并从脸盆的底部将止水密封圈、垫圈及固定螺母缩到落水上（注：不可用力过大，以免多脸盆造成破坏）

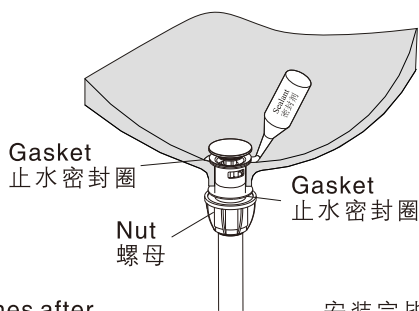

Users can press the body several times after installed to check if the rainspout works normally.

安装完毕，用户可以按压几次，测试落水是否正常工作

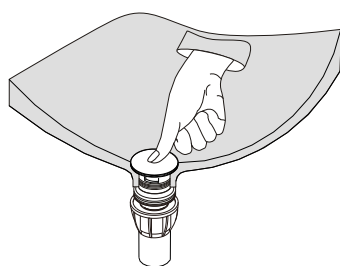

CARING FOR YOUR PRODUCTS

保养须知

1. Clean the product daily with cotton cloth.
Do not use abrasive materials.
2. Do not use strong chemical detergents such as strong acid, strong alkali or phosphoric acid.
3. Avoid scratching product surface with sharp objects.

1. 要经常除尘，因为灰尘每天都会粘在产品表面。最好使用干净的纯棉针织品作为抹布。
切记：请避免使用粗，磨料和钢丝球擦拭。
2. 请勿使用强力化学剂清洁（强酸，强碱或磷酸消毒剂）。
3. 产品均经过表面的打磨和抛光处理，避免有尖锐的硬物刮碰表面。

ONE-YEARS WARRANTY

一年有限担保

Our company provides one years warranty for its faucets valve to be leak and drip free during normal residential use. We also warrant all other aspects of its faucets to be free of defects of material and workmanship during normal residential use for one year. Our company will be responsible any problems caused by manufacturing defection, repair, replace or make appropriate adjustment when our company inspection discloses any such defects occurring in normal usage within warranty.

本产品自购买之日起，在正常使用下对制造和质料上的瑕疵提供一年的质量担保。在质保期内，凭购货发票，我司将免费承担由制造质量引起的任何问题。经核查后，我司有权决定是修理、更改、还是做适的调整。

The warranty, including products, is limited clearly. Our company is not responsible for other damages appeared after the warranty. Also, the warranty dose not cover problems arising from labor charges, incorrect use and installation.

这里的担保,包括产品都已明确地限制在该担保期内.本公司对以后出现的损坏不负任何责任.担保也不包括外观损伤,使用不当及未按说明书安装的损失。

Shanghai Kohler International Trade Co., Ltd.
Address: Room 1348, Floor 13, No.55, Xi Li Road,
China (Shanghai) Pilot Free Trade Zone
Tel: 400-920-8262
Postcode: 200131

上海科勒国际贸易有限公司
地址：中国（上海）自由贸易试验区西里路55号13层1348部位
电话：400-920-8262
邮编：200131