

# 卡丽 K A R A T<sup>®</sup>

## 安装说明书 INSTALLATION INSTRUCTIONS

## 维格落地式后排水商用坐便器 VOGUE FS P-TRAP TOILET 97803T-WK

### BEFORE YOU BEGIN

- Please read these instructions carefully to familiarize yourself with the required tools, materials, and installation sequences. Follow the sections that pertain to your particular installation. This will help you avoid costly mistakes. In addition to proper installation, read all operating and safety instructions.
- All information in these instructions is based upon the latest product information available at the time of publication. Karat reserves the right to make changes in product characteristics, packaging, or availability at any time without notice.
- These instructions contain important care, cleaning, and warranty information-please leave instructions for the consumer.

### 安装之前

- 请仔细阅读说明书，熟悉所需工具、材料和安装顺序，参照相关章节完成您所需的安装，以避免昂贵的损失，除了正确的安装外，请详阅所有的操作和安全说明。
- 本说明书所含的一切资料均以印刷时所有的最新产品为准，卡丽保留权利随时更改产品特性、包装或供应情况，恕不另行通知。
- 本说明书也包含了有关保养、清洁及产品担保等重要信息-请交予用户保存。

### ORDERING INFORMATION

#### COMB FOR VOGUE COM TOILET(FS, WO FM )

.....	21892T-WK
INCLUDES:	
IN-WALL TANK .....	76758T-WK
VOGUE WALL-HUNG P-TRAP BOWL .....	97803T-WK
SLOW-CLOSE TOILET SEAT & COVER .....	97809T-WK

#### COMB FOR VOGUE COM TOILET(FS, W/ FM )

.....	21893T-WK
INCLUDES:	
VOGUE IN-WALL TANK .....	12473T-M-NA
VOGUE WALL-HUNG P-TRAP BOWL .....	97803T-WK
SLOW-CLOSE TOILET SEAT & COVER .....	97809T-WK

COMB FOR COM TOILET & SENSOR.....	21040T-S-WK
INCLUDES:	
TOILET/SQUAT SENSOR.....	20657-ST
L PIPE.....	20122T-ST
VOGUE WALL-HUNG P-TRAP BOWL .....	97803T-WK
SLOW-CLOSE TOILET SEAT & COVER .....	97809T-WK

### 订购信息

维格商用坐便器组合（落地式，无框架）	.....21892T-WK
包括:	
隐藏式水箱 .....	76758T-WK
维格挂墙式后排水-缸体 .....	97803T-WK
维格商用坐便器-盖板 .....	97809T-WK

维格商用坐便器组合（落地式，有框架）	.....21893T-WK
包括	
维格隐藏式水箱 .....	12473T-M-NA
维格挂墙式后排水-缸体 .....	97803T-WK
维格商用坐便器-盖板 .....	97809T-WK

商用坐便器和感应器组合 .....	21040T-S-WK
包括:	
蹲/坐便器感应器 .....	20657-ST
L型弯管 .....	20122T-ST
维格挂墙式后排水-缸体 .....	97803T-WK
维格商用坐便器-盖板 .....	97809T-WK

### 用水量说明:

小档4.2L，大档6.0L，平均用水量 4.8L为产品名义用水量，计算方法依GB/T 6952-2015 6.2.1项,两次小档加一次大档用水量总和除以3。

### NOTES

- Observe all local plumbing and building codes.
- Shut off the water supply.
- For values of seat post hole centers, please refer to dimension.
- Please refer to actual for the value of water depth from rim.
- Ensure that the new drain and shut-off valve have the correct roughing-in dimensions.
- Be very careful while working with vitreous china products. Vitreous china can break or chip if the bolts or nuts are overtightened, or if carelessly handled.
- Carefully inspect the new bowl for any sign of damage.

### 注意

- 请遵守当地所有给排水及建筑规定。
- 关闭供水。
- 坐便器盖板孔中心间距请参考尺寸图。
- 坐便器上表面距离水面以具体实物为准。
- 确保新排污管和止水阀坑距尺寸正确。
- 请小心处理釉面陶瓷产品，因其容易破损和崩裂，故不可把螺栓或螺母上得过紧，且须小心轻放。
- 请仔细检查坐便器是否有损坏。

## TOOLS AND MATERIALS REQUIRED (Not supplied)

- 254mm adjustable wrench
- Metal file (file cut)
- Tape measure
- Tubing cutter
- Level
- Hacksaw
- Putty knife
- Screwdriver
- Straight pipe coupling

## 所需工具及材料(不随货供应)

- 254mm活动板钳
- 锉刀
- 卷尺
- 切管刀
- 水平尺
- 钢锯
- 涂油灰刀
- 螺丝刀
- 联结直管
- 联结组件

## ROUGHING-IN

## 尺寸图

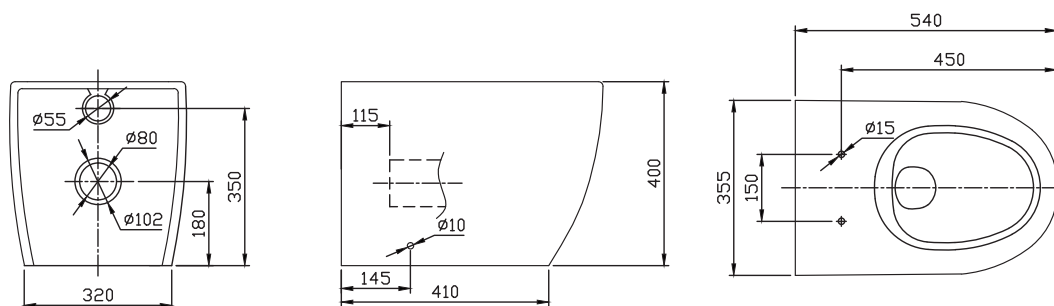

Unit: mm  
单位: 毫米

The size is for reference only, please check the actual size before installation.  
此尺寸仅供参考，安装前请仔细测量实际产品。

## INSTALLATION

## 安装

### 1. INSTALL THE TANK

- Turn the water supply off before installing the new toilet.
- Install the concealed tank system in wall before decorating the wall.
- Install the tank system per tank's installation instructions.

Recommended in wall tanks

1) Vogue 9Lin wall tank and cover: 12469T-NA

2) Vogue 6Lin wall tank and cover: 12473T-NA

\*For concrete installation steps, please refer to the installation instructions for 12469T-NA and 12473T-NA

#### 1. 安装水箱

- 安装新坐便器前先关闭供水。
- 在装饰墙面前先将入墙式水箱系统安装入墙体内。
- 参照水箱安装说明书完成水箱系统的安装。

推荐使用的入墙式隐藏水箱

1) 维格9升入墙式隐藏水箱12469T-NA

2) 维格6升入墙式隐藏水箱12473T-NA

\*安装方法参考12469T-NA和12473T-NA说明书。

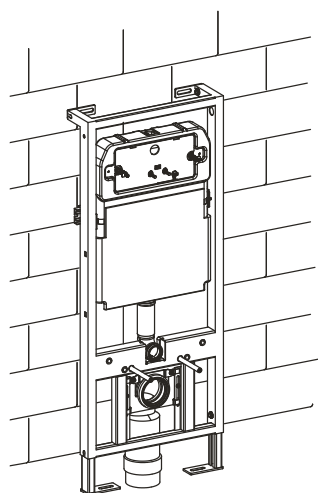

### 2. SET THE SPACING OF THE BOWL

Be careful to set the spacing of set aside the length for carrier studs and tighten nut .the bowl on wall according to the dimension as shown.

### 2. 坐便器定位

根据图示尺寸，小心地在墙面上定好坐便器进水和排水的位置。

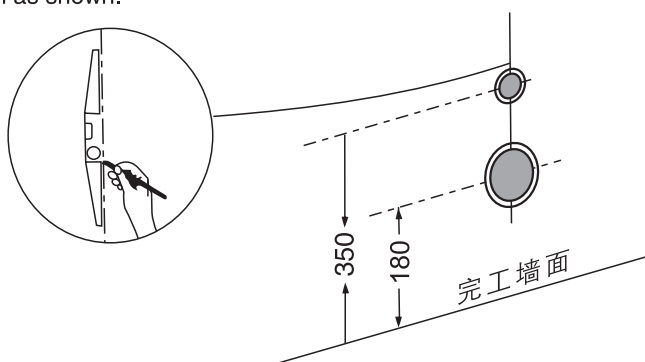

Unit: mm  
单位: 毫米

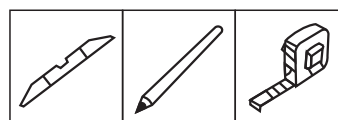

### 3. ATTACH CONNECTION PIPE

- Attach pipe with gasket to the inlet to link to the concealed tank.
- Attach pipe with gasket to the outlet.
- \*Apply gasket for sealing the bowl to wall.
- You may apply some lubricant to help connect smoothly.

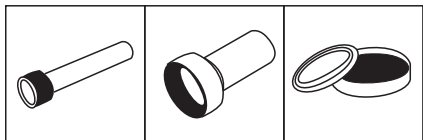

### 3. 安装联结管

- 联结管装上垫圈，接上入水口，联结入墙式水箱。
- 联结管装上垫圈，接上排污口。
- \*垫圈使坐便器与墙面间严丝合缝。
- 可以使用润滑剂，有助联结。

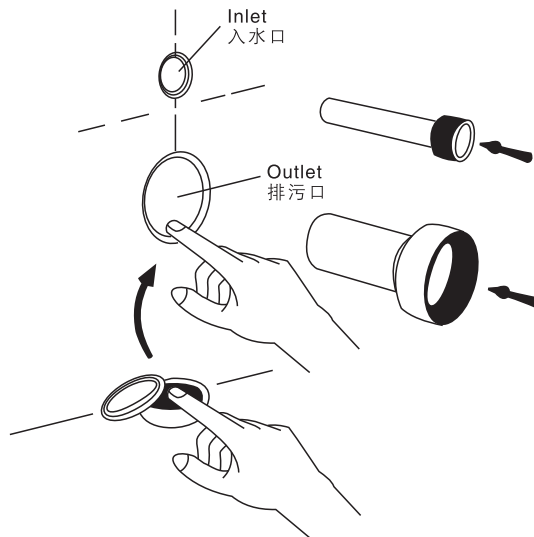

### 4.

- 1) Put the bowl in position and mark a line the back of the bowl.
- 2) connected toilet with inlet and outlet.
- 3) fit the clamps to the floor with the floor plugs, washers and nuts.

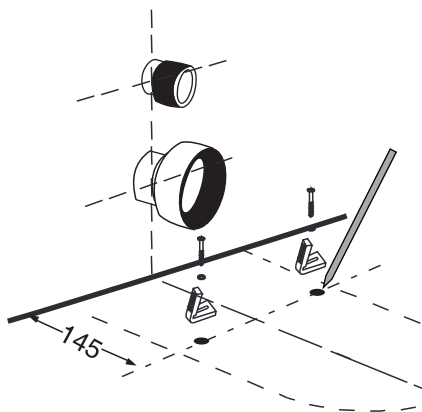

- 4) Apply sealant to make sure the bowl's edge seals to the wall.
- 4) 使用密封胶，保证坐便器边缘紧贴墙面。

### 4.

- 1) 将坐便器放在预装地面上,在安装位置划线.并用电钻在地面上钻出安装孔.
- 2) 将坐便器和进排水管连接.
- 3) 用地面膨胀管, 垫片, 螺母将地脚安装螺丝固定在地面上

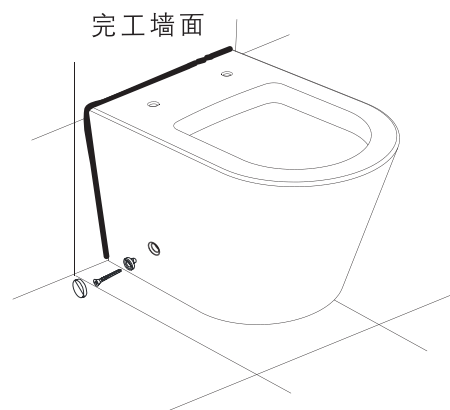
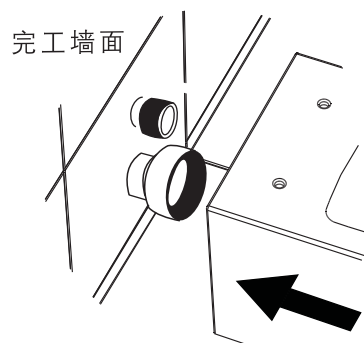

## FINISH THE INSTALLATION

1. Ensure that all the connections are tight.
2. Turn on the water supply and check for any leaks.
3. Flush the toilet to check for correct operation.

## 完成安装

1. 确保所有连接已旋紧。
2. 打开供水管路以检查渗漏。
3. 试冲水以确定坐便器安装正确。

## IMPORTANT CONSUMER INFORMATION 用户须知

### CONSUMER RESPONSIBILITIES

When cleaning up after installation, do not use abrasive cleansers, as they may scratch and dull the toilet surface. Use warm water and a liquid detergent to clean the surface.

Remove stubborn stains, paint, or tar with turpentine or paint thinner. Do not allow cleaners containing petroleum distillates to remain in contact with any toilet surface for long periods of time.

Remove plaster by carefully scraping with a wood edge. Do not use metal scrapers, wire brushes, or other metal tools. Use a powder type detergent on a damp cloth to provide mild abrasive action to any residual plaster.

Clean the outside surface of your vitreous china product with mild soap and warm water. Wipe the entire surface completely dry with a clean, soft cloth.

Most toilet bowl cleaners are not harmful to the vitreous china surface of the toilet bowl. Please follow the bowl cleaner manufacturer's instructions carefully.

Do not use abrasive cleaners or solvents.



**WARNING: Risk of property or product damage.**

Do not use in-tank cleaners. Products containing chlorine (calcium hypochlorite) can seriously damage fittings in the tank. This damage can cause leakage and property damage.

Karat shall not be responsible or liable for any damage to these tank fittings caused by the use of cleaners containing chlorine (calcium hypochlorite).



**CAUTION: Do not use any cement while installing the toilet.** Heat expansion of the toilet may damage the feet of the toilet. Karat will not be responsible for any damage because of using cement.



**WARNING: Risk of product damage.**

Do not throw into the toilet what is easy to block it, such as newspaper, paper pilch, sanitary towel. Do not bump the vitreous china with great force to prevent it from damaging and leaking. Do not use the product in the water below 0°C.

### 用户责任

安装完成进行清理时，切勿使用腐蚀性清洁剂，因为它们会刮伤坐便器表面，使色彩变得黯淡。使用温水和液体清洁剂来清洁表面。

使用松节油或油漆稀释剂，清除顽固污渍、油漆或柏油。切勿让含有石油提炼物的清洁剂长时间接触坐便器表面。

使用木片小心地刮除油灰，切勿使用金属刮刀，钢丝球，或其它的金属工具。使用粉末状清洁剂和湿布柔和地擦去油灰。

使用中性肥皂和温水清洁釉面陶瓷产品的表面。擦拭整个表面，用干净的软布擦干。

大多数马桶清洁剂对坐便器表面是无害的，请认真遵循马桶清洁剂制造商的指示来操作。

请勿使用腐蚀性清洁剂或溶剂。



**警告：提防楼宇受损或损坏产品。**请勿使用水箱内用清洁剂。含氯（次氯酸钙）的清洁剂会严重破坏水箱配件，从而引起渗漏，或对楼宇结构造成损坏。

卡丽对此类因使用氯(次氯酸钙)而引致的水箱装置损毁，概不负责。



**警告：在安装本坐便器时切勿使用任何水泥。**因为水泥的热膨胀可能使坐便器的脚部挤破或损坏。卡丽对所有因为水泥安装而引起的坐便器破裂恕不负责。



**警告：提防损坏产品。**请不要向便器内冲入新闻纸、纸尿裤、妇用卫生巾等容易堵塞的物品。请不要用重力撞击陶瓷，以防止破损漏水。

不要在0°C以下的水环境中使用。

## **ONE-YEAR LIMITED WARRANTY**

Karat warrants its product to be free of defects in material and workmanship for one (1) year from date of purchase. This warranty only applies to Karat product purchased and installed in mainland China.

Karat will, at its election, repair, replace, or make appropriate adjustment where Karat inspection discloses any such defects occurring in normal use during the warranty period. Karat is not responsible for removal or installation costs. Damage caused by accident, misuse, or abuse is not covered by this warranty. Improper care and cleaning will void the warranty.\*

If you believe that you have a warranty claim, contact Karat through your Dealer, Plumbing Contractor, Home Center or E-tailer. Please be sure to provide all pertinent information regarding your claim, including a complete description of the problem, the product, model number, color, finish, the date the product was purchased and from whom the product was purchased. Also include your proof of purchase (original sales receipt).

KARAT AND/OR SELLER ARE PROVIDING THESE WARRANTIES IN LIEU OF ALL OTHER WARRANTIES, EXPRESSED OR IMPLIED, INCLUDING BUT NOT LIMITED TO THE IMPLIED WARRANTIES OF MERCHANTABILITY AND FITNESS FOR A PARTICULAR PURPOSE. KARAT AND/OR SELLER DISCLAIM ALL LIABILITY FOR SPECIAL, INCIDENTAL OR CONSEQUENTIAL DAMAGES.

**This is Karat's exclusive written warranty.**

### **一年有限担保**

卡丽担保本产品自购买之日起一年内无材料及制造工艺上的瑕疵。本担保仅适用于在中国大陆购买并安装的卡丽产品。

在担保期内，如经卡丽核查后发现产品在正常使用的情況下存在瑕疵，卡丽将自行决定对产品进行修理、更换、或是作适当的调整。卡丽不承担上述成本以外的人工成本、拆除或安装的成本。由于意外、过度使用或或使用不当造成的产品损害不属于担保范围之内。不适当的保养和清洁将导致担保无效。

为获得担保服务，请通过您的经销商、承包商、家居中心或网络零售商联系我们。请确保提供所有相关的信息，包括完整的问题描述、型号、颜色、表面镀层、购买时间及销售方。请务必同时提供购买凭证（原销售发票）。

在法律允许的范围内，卡丽及/或销售商提供此担保以取代所有其他明示或默示的担保（包括但不限于产品的适销性和适用于特定目的的担保），并且卡丽及/或销售商对任何特殊、附带或衍生性损害赔偿不承担责任。

这是我们全部的书面担保。

Shanghai Chehe Trading Co., Ltd.  
Address: Floor 2, No. 126, 128, 130 Jiang Chang San Road,  
Jing An District, Shanghai.  
Tel: 400-920-8262      Postcode: 200436

上海澈和贸易有限公司

地址：上海市静安区江场三路126、128、130号2层  
电话：400-920-8262      邮编：200436

# 卡丽 K A R A T<sup>®</sup>

## 维修零件图 SERVICEPARTSPAGE

维格落地式后排水商用坐便器  
VOGUE FS P-TRAP TOILET  
97803T-WK

